



Price excludes: Fencing, Landscaping, Concrete pavers, Planter boxes, Decking

\$705,409*

LOT 1822, COQUINA DRIVE
THE POINT ESTATE
POINT LONSDALE

DELTA 21 (LIMITED EDITION)
LUXE FACADE

BLOCK SIZE | 400M²

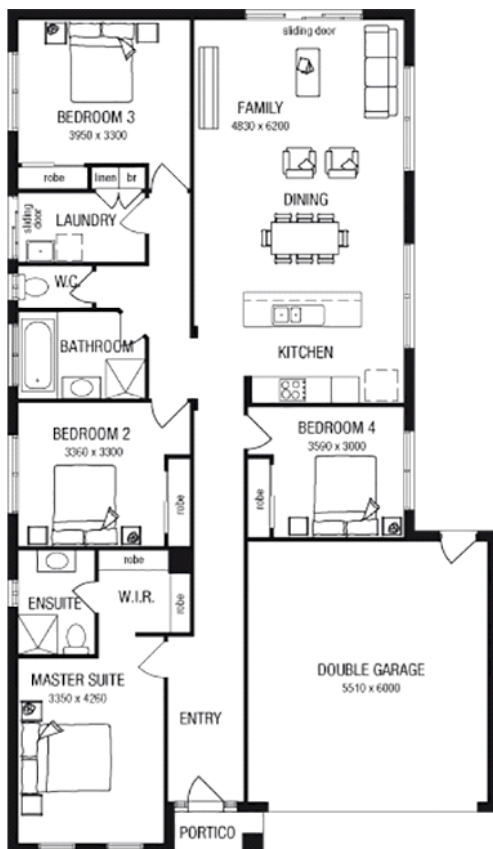

PACKAGE INCLUDES:

THE DELTA 21 (LIMITED EDITION) WITH LUXE FACADE BUILT TO OUR INDUSTRY LEADING BASE SPECIFICATIONS AND LAND, PLUS:

- ✓ 20mm stone benchtop to Kitchen
- ✓ Large 900mm wide stainless steel appliances
- ✓ Laminate overhead kitchen cupboards (2 sets)
- ✓ Gas ducted heating
- ✓ Remote control garage door
- ✓ Concrete driveway and path (up to 35m²)
- ✓ BAL 12.5 requirements[^]
- ✓ Fibre optic package
- ✓ Lifetime structural guarantee[#]
- ✓ Concrete slab to outdoor room
- ✓ Floor Coverings
- ✓ Eaves



1300 METRICON |
www.metricon.com.au

KRISTINA NIKOLOVSKA

FREEDOM

m
metricon

*Image includes upgrade items and may depict fixtures, finishes and features not supplied by Metricon such as landscaping and fencing. Accordingly, any prices in this flyer do not include the supply of those items. Floor plan is a representation of a Traditional façade unless otherwise stated. Metricon reserves the right to alter the images or descriptions without notice. Home & land package prices are correct at time of printing and subject to change without notice. Land prices and availability are subject to change without notice. \$sitecostypetoken\$ Pricing does not include additional legal fees relating to the building and/or land contract and stamp duty charges. All home & land packages are subject to developer approval. VIC Builder's Licence: CDB-U 52967 # For details on our Lifetime structural guarantee visit metricon.com.au/terms/structuralguarantee. See metricon.com.au for full details of standard inclusions and/or terms and conditions. +Typical site cost allowance included in the price. Additional site costs may apply if site survey and soil tests indicate the presence of fill or more than 300mm of land fall or presence of rock above the typical site allowance made. Package Printed Date: 22/07/2021 Price Region: Geelong.